



LOW BATTERY MESSAGE

Revision: August 2018

WHAT THIS GUIDE IS ABOUT

This guide is designed to help outline the procedure to fix the “Low Battery” warning message on the Universal Control Panel (UCP).

This alarm message shows the status of the over-temperature circuit in the material processing area and indicates if the Thermal Sensor circuit battery is low in power. During normal operation, if the Thermal Sensor inside the laser system is triggered, an alarm will sound, and the laser will be shut down.

When the battery is low in power or even removed from the system, the laser machine will still move the motion system as commanded but will not fire the laser when running a job.

If you require further help with the information contained in this guide, please contact the LST Group support department at support@lstgroup.com.au

THE “LOW BATTERY” MESSAGE

The “Low Battery” message will appear on the bottom left hand corner of the Universal Control Panel. When the battery is low in power, the system will not “fire” the laser and will display the “Low Battery” message.

BATTERY REPLACEMENT

To replace the battery, please purchase a new 9 Volt battery of a reputable brand such as Energizer or Duracell, as lesser known brands may not clear the message as they supply insufficient power for the circuit.

Avoid using older unused batteries as their charge may have depleted over time.

On the next page, the location of the battery compartment is outlined for each of the series of Universal Laser machines.

To replace the battery:

- 1- Slide out the battery holder by using your finger or a flat head screw driver to lift the holder which should then pop out enough to be pulled out completely.
- 2- Replace the battery, following the polarity guide on the holder.
- 3- Reinsert the holder firmly.
- 4- The warning message should clear from the UCP.

You can test the thermal sensor alarm by using a pen in the recessed button next to the holder to sound the alarm.

VLS DESKTOP

When standing in front of the laser machine the battery holder is located on the lower rear right side.

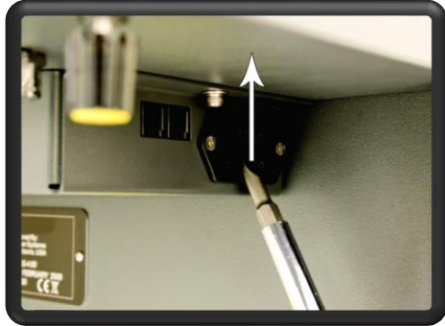
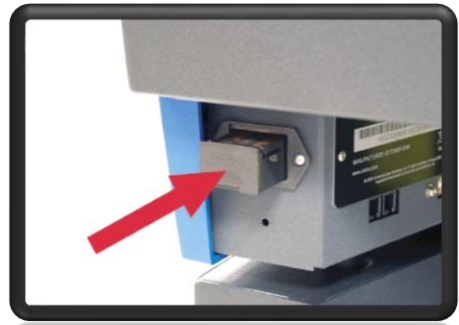

VLS PLATFORM

The location of the battery compartment for a VLS platform series is located on the left-hand side of the machine, at the rear, underneath the laser tube compartment.

PLS PLATFORM

When standing in front of your laser machine, the battery compartment is located on the right-side panel near the back of the machine next to the USB cable.

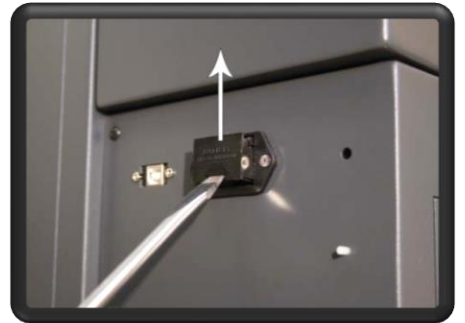

ILS PLATFORM

The battery compartment is located on the rear of the machine next to the USB cable.

CONTACT US

LST GROUP

109 Bonds Rd Punchbowl NSW 2196
Phone: 61 2 9584 9499 Fax: 61 2 9584 9550
LSTGroup.com.au
Sales: sales@lstgroup.com.au
Support: support@lstgroup.com.au